

# GUDEN-MCMILLIAN SUBDIVISION

# HOMER TOWNSHIP SECTION 29 R13 TWP 7 MORGAN COUNTY, OH

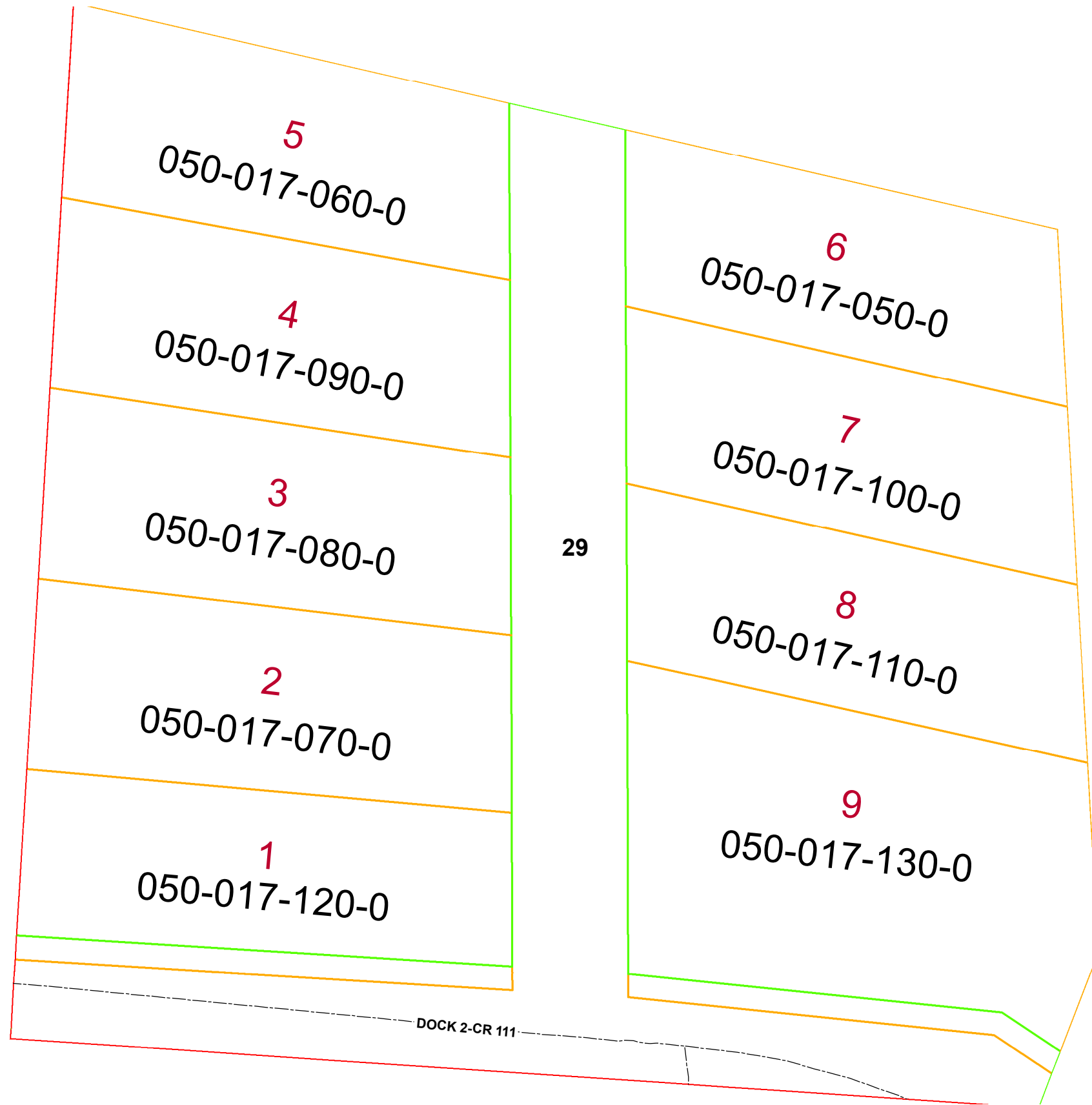

PIN	VOL	PAG	Owner	LegalDescr	Acre
050-017-070-0	OR208	2531	BROWN DONALD & TERESA	GUDEN MCMILLAN LOTS IN LOT 2	0.364
050-017-080-0	OR208	2531	BROWN DONALD & TERESA	GUDEN MCMILLAN LOTS IN LOT 3	0.355
050-017-090-0	OR177	780	BROWN DONALD P & TERESA A	GUDEN MCMILLAN LOTS IN LOT 4	0.347
050-017-110-0	OR181	323	COE RICHARD	GUDEN MCMILLAN LOTS IN LOT 8	0.343
050-017-100-0	OR181	323	COE RICHARD	GUDEN MCMILLAN LOTS IN LOT 7	0.336
050-017-050-0	OR181	323	COE RICHARD	GUDEN MCMILLAN LOTS IN LOT 6	0.329
050-017-060-0	OR4	322	COE RICHARD A	GUDEN MCMILLAN LOTS IN LOT 5	0.345
050-017-120-0	OR201	505	KITTLE JUDY ANN	GUDEN MCMILLAN LOTS IN LOT 1	0.381
050-017-130-0	OR131	670	MURPHY WILLIAM H JR & JUDITH M	GUDEN MCMILLAN LOTS IN LOT 9	0.603

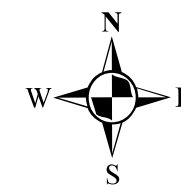

Boundaries	
----- Hidden	----- ROW
----- Hydro	----- Section
----- Roads	----- Lot
----- County	----- Parcel
----- Township	----- Parcels

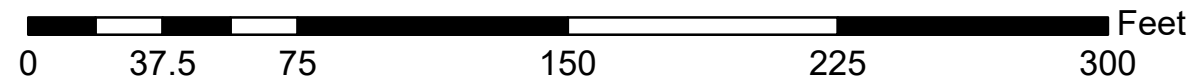

Disclaimer: The information that these maps contains is for reference purposes only. Please bring any errors to the attention of the Engineer's Office staff.  
Thank you